



WPS1.2-50 Ni-Cad (1.2V50AH)



Nickel-cadmium battery which made of pocket plate is characterized by compact construction, low internal resistance, high reliability, high capacity, long service life and excellent low temperature performance. The battery is particularly suitable for long discharge periods such as UPS, Electrical power system, Telecommunications system, Mass transit system, Photovoltaic, Energy storage battery for wind, solar and other renewable energy power systems, petrochemical industry, fire security system, They can also be used for starting, in transport vehicles and solar energy cells.

Nominal Voltage/额定电压		1.2V			
Capacity(20°C)/容量		50Ah			
Max discharge current/最大放电电流		25A	175A	375A	500A
Max charging current/最大充电电流		12.5A	12.5A	12.5A	12.5A
Dimension 尺寸 (mm)	Length/长	141	139	139	138
	Width/宽	71	79	79	61
	Total Height/总高	295	295	370	266
Weight(kg/pc)/重量 (Whit Electrolyte)		3.5 (0.9L)	4.65 (1.0L)	6.2 (0.4L)	3.5 (0.5L)
Internal resistance/内阻, Ω (Fully charged, 20°C)		0.005	0.003	0.002	0.001
Float charging voltage(20°C)/浮充电压		1.48~1.5V	1.42~1.45V	1.39~1.41V	1.35~1.38V
Container Material 外壳材料		PP	ABS	ABS	ABS
1 pallet: 1000*500*500mm		45pcs/pallet	42pcs/pallet	42pcs/pallet	56pcs/pallet
Capacity affected by temperature (5HR)	20°C	≥100%			
	-18°C	≥80%			
Self-discharge(20°C)	3 month	<30%			
Nominal operating temperature		20°C±5°C			
Operating temperature range		-20°C~50°C			
Terminal material		Nickel- Clad Steel			

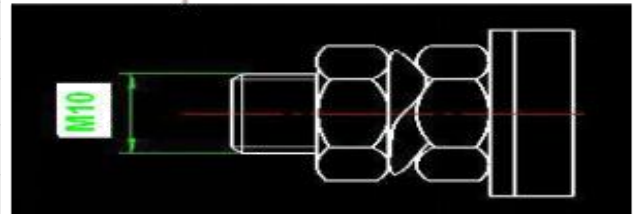
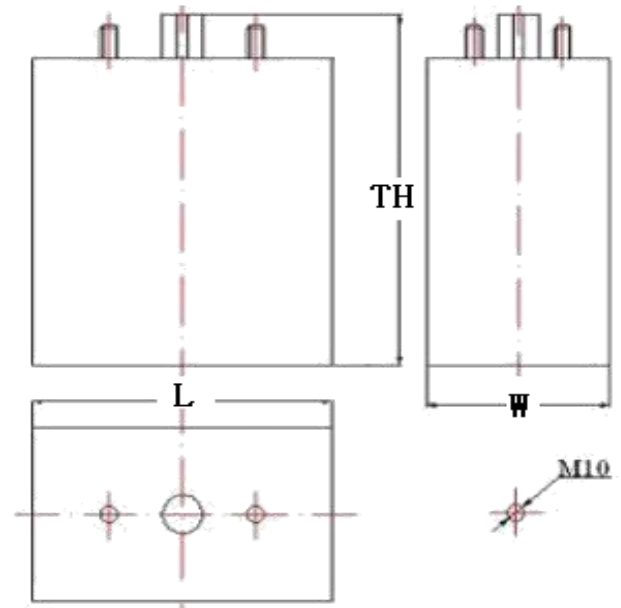

Charging curves of 0.2C₅A (20±5°C)

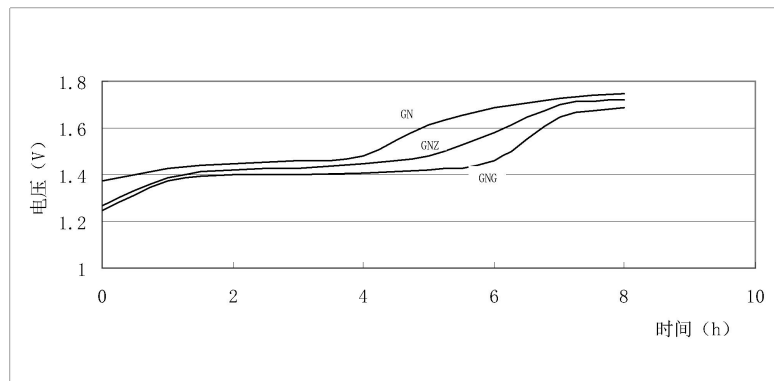

Discharge curves of 20±5°C

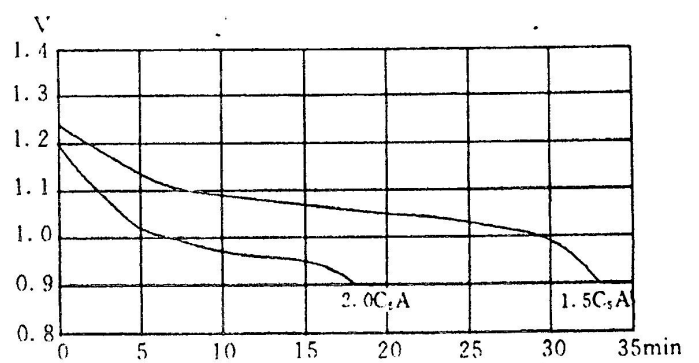

Low temperature(-18°C) discharge curve 0.2C₅A

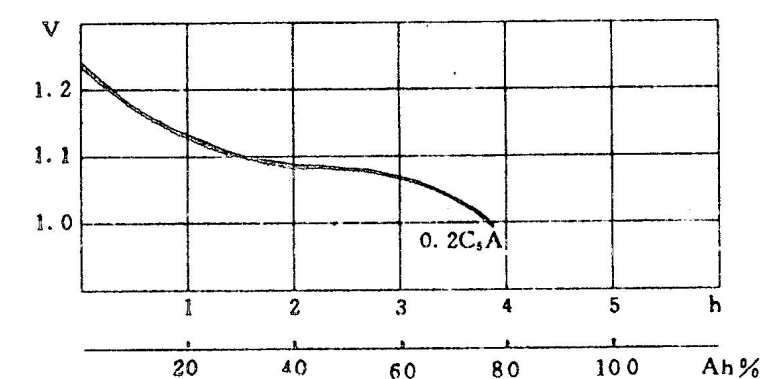

Instantaneous discharge curves after 1h of various discharge rates, 1.45V/cell float charge

